

Ecoflam

TECHNICAL CATALOGUE



RANGE OVERVIEW

Low NOx Classe 3 (NOx ≤ 80 mg/kWh)

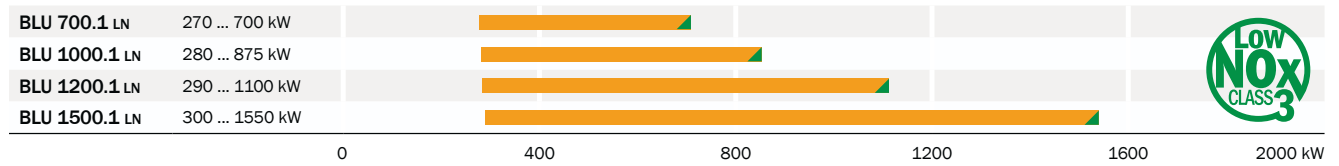

Low NOx Classe 2 (NOx ≤ 120 mg/kWh)

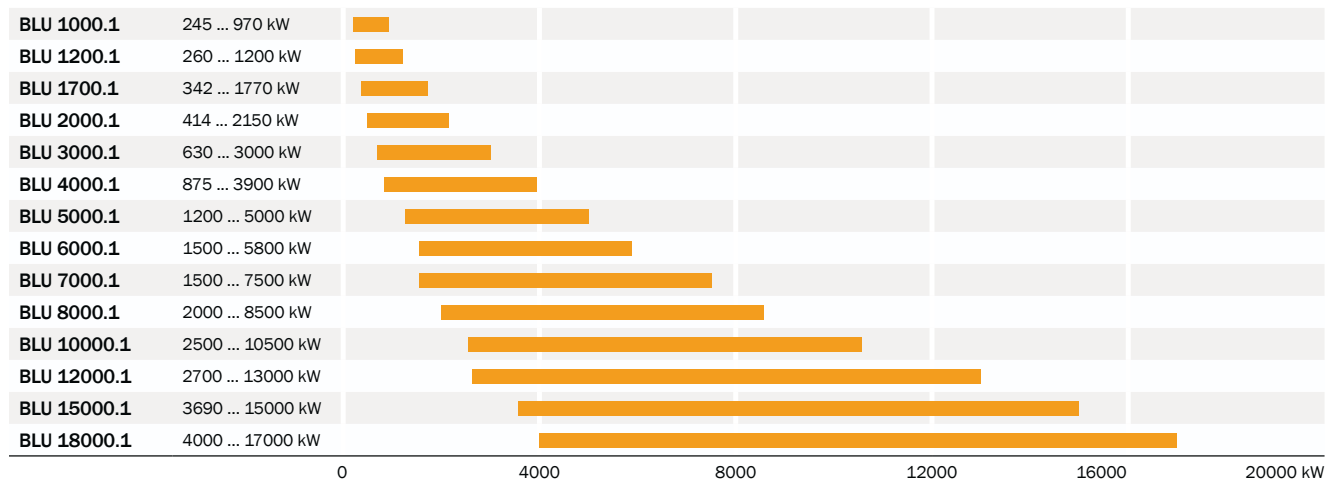

MAIN FEATURES

- Modulating version with PID controller with digital set point display and real time value
- Version with fully electronic Burner Management System available for all models
- Adjustable combustion head for easy regulation and matching with different combustion chambers
- High turndown ratio up to 1:8
- Configured and special versions on request according to feasibility

BLU 500.1 PAB



BLU 700.1 PAB



BLU 2000.1 PAB



CONFIGURATIONS

BLU range is available in the following operation modes:

BLU ... PAB	Two stages Two stages Low NOx Class 3	BLU 700.1 ... 2000.1 BLU 700.1 LN ... 1500.1 LN
BLU ... PR	Two stage progressive/modulating mechanical Two stage progressive/modulating mechanical Low NOx Class 3	BLU 1000.1 ... 18000.1 BLU 700.1 LN ... 1500.1 LN
BLU ... PRE	Two stage progressive/modulating electronic Two stage progressive/modulating electronic Low NOx Class 3	BLU 1000.1 ... 18000.1 BLU 700.1 LN ... 1500.1 LN

Other available configurations:

- LPG versions up to BLU 6000.1
- Continuous ventilation versions
- Swirl system for flame geometry customization
- OEM and other special versions on request according to feasibility

FUEL

- Natural gas (G20, G25 according to EN676)
- LPG

EMISSIONS

Class	NOx mg/kWh
1	170
2	120
3	80

All models are in compliance with EN 676 European Standard

CONFORM TO

- All products are in accordance with the following directives:
- 2006/42/EC Machinery Directive
 - 2014/30/UE EMC Directive
 - 2014/35/UE Low Voltage Directive
 - 2009/142/CEE Gas Appliances Directive



- Fuels: natural gas, LPG
- Operation: two stages, two stage progressive or modulating with the installation of a power regulator and dedicated probes (see page 102)
- Emission class: Low NOx class 3 (≤ 80 mg/kWh) according to EN676

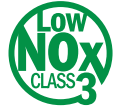

WORKING DIAGRAM

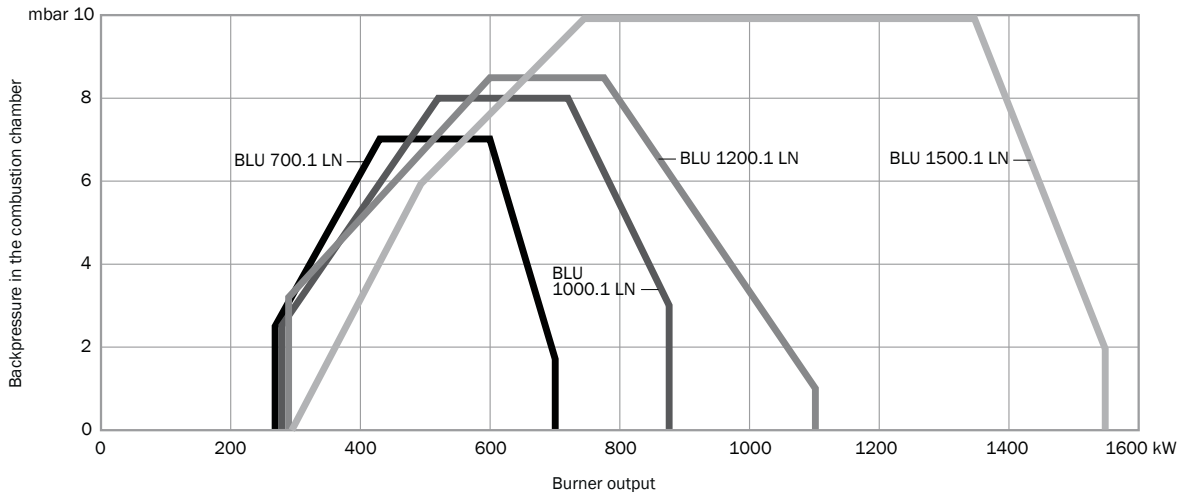

TECHNICAL DATA

	Burner output (kW)	Power supply	Motor (kW)	NOx class	Operation
BLU 700.1 LN	270 - 700	3/230-400/50Hz	1,1	Class 3	PAB, PR, PRE
BLU 1000.1 LN	280 - 875	3/230-400/50Hz	1,1	Class 3	PAB, PR, PRE
BLU 1200.1 LN	290 - 1100	3/230-400/50Hz	2,2	Class 3	PAB, PR, PRE
BLU 1500.1 LN	300 - 1550	3/230-400/50Hz	3	Class 3	PAB, PR, PRE

OVERALL DIMENSIONS

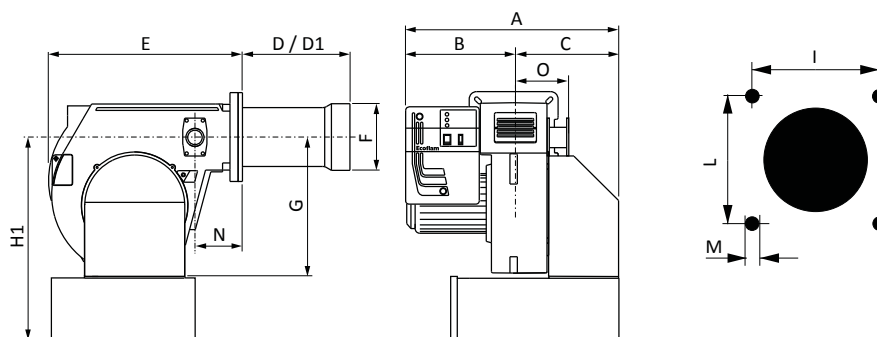

Dimensions in mm
 Head length: D short / D1 long
 *: with silencer (optional)

	A	B	C	D	D1	E	F	G	H1*	I	L	M	N	O
BLU 700.1 LN	650	330	320	175	395	555	170	390	600	190	190	M10	140	165
BLU 1000.1 LN	650	330	320	175	395	555	190	390	600	190	190	M10	140	165
BLU 1200.1 LN	670	350	320	310	460	555	200	390	600	190	190	M10	140	165
BLU 1500.1 LN	712	364	348	340	540	730	215	420	680	240	240	M14	138	187

BURNERS

Two stages, Low NOx class 3

Model	Head	Code
BLU 700.1 LN PAB	TC	3143977
	TL	3143978
BLU 1000.1 LN PAB	TC	3143988
	TL	3143989
BLU 1200.1 LN PAB	TC	3143994
	TL	3143995
BLU 1500.1 LN PAB	TC	3144001
	TL	3144002



BLU 700.1 LN PR

Two stage progressive/modulating mechanical, Low NOx class 3

Model	Head	Code
BLU 700.1 LN PR	TC	3143984
	TL	3143985
BLU 1000.1 LN PR	TC	3143990
	TL	3143991
BLU 1200.1 LN PR	TC	3143996
	TL	3143997
BLU 1500.1 LN PR	TC	3144003
	TL	3144004

Two stage progressive/modulating electronic, Low NOx class 3

Model	Head	Code
BLU 700.1 LN PRE	TC	3145108
	TL	3145109
BLU 1000.1 LN PRE	TC	3145110
	TL	3145111
BLU 1200.1 LN PRE	TC	3145112
	TL	3145113
BLU 1500.1 LN PRE	TC	3145114
	TL	3145115

OTHER AVAILABLE CONFIGURATIONS

60 Hz	LPG	Continuous Ventilation (CV)	Post-purge
●	○	●	●

- Codes available on request
- Conversion kit from natural gas to LPG: see pag. 112

GAS TRAINS

	Pressure (mbar)		Model	Size	Codes for PAB and PR	Codes for PRE versions	Connection pipe	Filter
	min	max						
for BLU 700.1 LN	17	360	MB-DLE 420	2"	3141847	3144273	-	included
	25	360	MB-DLE 415	1"1/2	3141846	3144272	-	included
	75	360	MB-DLE 410	1"	3142022	3144270	-	included
for BLU 1000.1 LN	35	360	MB-DLE 420	2"	3141847	3144273	-	included
	40	360	MB-DLE 415	1"1/2	3141846	3144272	-	included
	75	360	MB-DLE 412	1"1/4	3141845	3144271	-	included
for BLU 1200.1 LN	20	500	VDG 20.503	2"	3123860	3144277	-	3121384
	35	360	MB-DLE 420	2"	3141847	3144273	-	included
	45	360	MB-DLE 415	1"1/2	3141846	3144272	-	included
for BLU 1500.1 LN	85	360	MB-DLE 412	1"1/4	3141845	3144271	-	included
	30	500	VDG 40.065	DN65	3124110	3144278	3141842	3124111
	40	500	VDG 20.503	2"	3123860	3144277	3142076	3121384
	60	360	MB-DLE 420	2"	3141847	3144273	3142076	included
	70	360	MB-DLE 415	1"1/2	3141846	3144272	3142076	included

- ! For minimum inlet pressures higher than 250 mbar, choose the pressure switch GW500 (to be fitted during installation on site) - see page 105
- For gas trains in EN676 Configuration a tightness control device must be included over 1200 kW (already included on PRE burners) - see page 112

- Fuels: natural gas, LPG
- Operation: two stages, two stage progressive or modulating with the installation of a power regulator and dedicated probes (see page 102)
- Emission class: Low NOx class 2 (≤ 120 mg/kWh) according to EN676

WORKING DIAGRAM

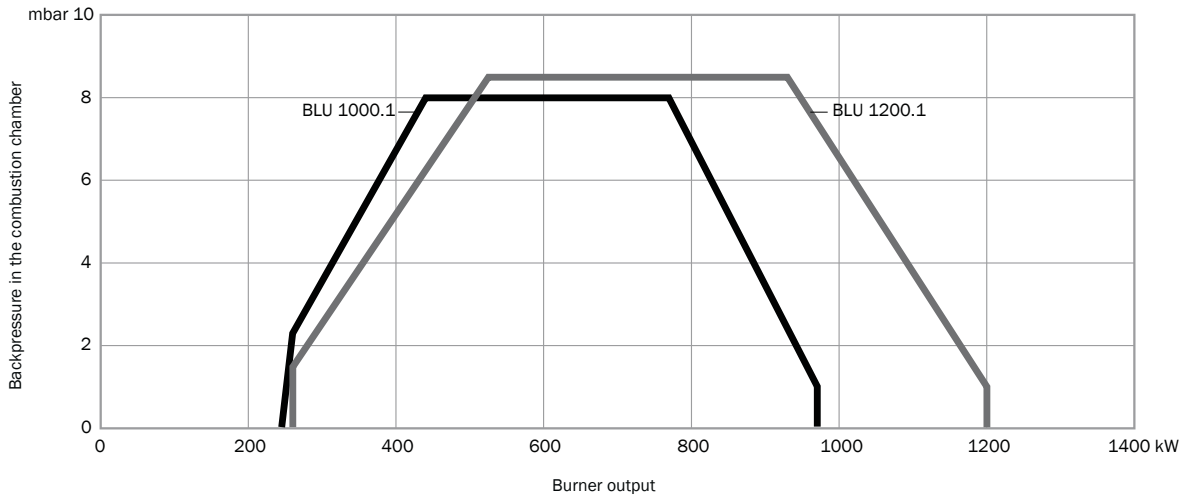

TECHNICAL DATA

	Burner output (kW)	Power supply	Motor (kW)	NOx class	Operation
BLU 1000.1	245 - 970	3/230-400/50Hz	1,1	Class 2	PAB, PR, PRE
BLU 1200.1	260 - 1200	3/230-400/50Hz	2,2	Class 2	PAB, PR, PRE

OVERALL DIMENSIONS

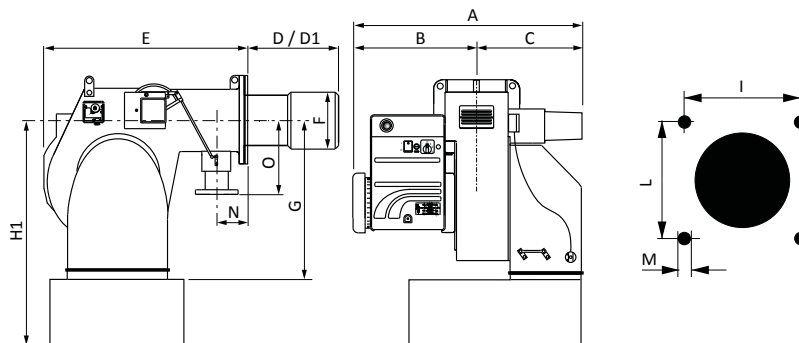

Dimensions in mm
 Head length: D short / D1 long
 *: with silencer (optional)

	A	B	C	D	D1	E	F	G	H1*	I	L	M	N	O
BLU 1000.1 PAB	608	328	280	174	394	543	190	401	601	185/200	185/200	M10	138	168
BLU 1200.1 PAB	608	328	280	309	459	543	200	401	601	185/200	185/200	M10	138	168
BLU 1000.1 PR	657	328	329	174	394	543	190	401	601	185/200	185/200	M10	138	420
BLU 1200.1 PR	657	328	329	309	459	543	200	401	601	185/200	185/200	M10	138	420
BLU 1000.1 PRE	702	422	280	174	394	651	190	401	601	185/200	185/200	M10	138	168
BLU 1200.1 PRE	702	422	280	309	459	651	200	401	601	185/200	185/200	M10	138	168

BURNERS

Two stages

Model	Head	Code
BLU 1000.1 PAB	TC	3144040
	TL	3144041
BLU 1200.1 PAB	TC	3144043
	TL	3144044

Two stage progressive/modulating mechanical

Model	Head	Code
BLU 1000.1 PR	TC	3144045
	TL	3144046
BLU 1200.1 PR	TC	3144047
	TL	3144048

Two stage progressive/modulating electronic

Model	Head	Code
BLU 1000.1 PRE	TC	3145116
	TL	3145117
BLU 1200.1 PRE	TC	3145118
	TL	3145119



BLU 1000.1 PAB

OTHER AVAILABLE CONFIGURATIONS

60 Hz	LPG	Continuous Ventilation (CV)	Post-purge
●	○	●	●

- Codes available on request
- Conversion kit from natural gas to LPG: see pag. 112

GAS TRAINS

	Pressure (mbar)		Model	Size	Codes for PAB and PR	Codes for PRE versions	Filter
	min	max					
for BLU 1000.1	27	360	MB-DLE 420	2"	3141847	3144273	included
	35	360	MB-DLE 415	1"1/2	3141846	3144272	included
	75	360	MB-DLE 412	1"1/4	3141845	3144271	included
for BLU 1200.1	25	500	VGD 20.503	2"	3123860	3144277	3121384
	40	360	MB-DLE 420	2"	3141847	3144273	included
	50	360	MB-DLE 415	1"1/2	3141846	3144272	included
	100	360	MB-DLE 412	1"1/4	3141845	3144271	included

! For minimum inlet pressures higher than 250 mbar, choose the pressure switch GW500 (to be fitted during installation on site) - see page 105

- Fuels: natural gas, LPG
- Operation: two stages, two stage progressive or modulating with the installation of a power regulator and dedicated probes (see page 102)
- Emission class: Low NOx class 2 (≤ 120 mg/kWh) according to EN676

WORKING DIAGRAM

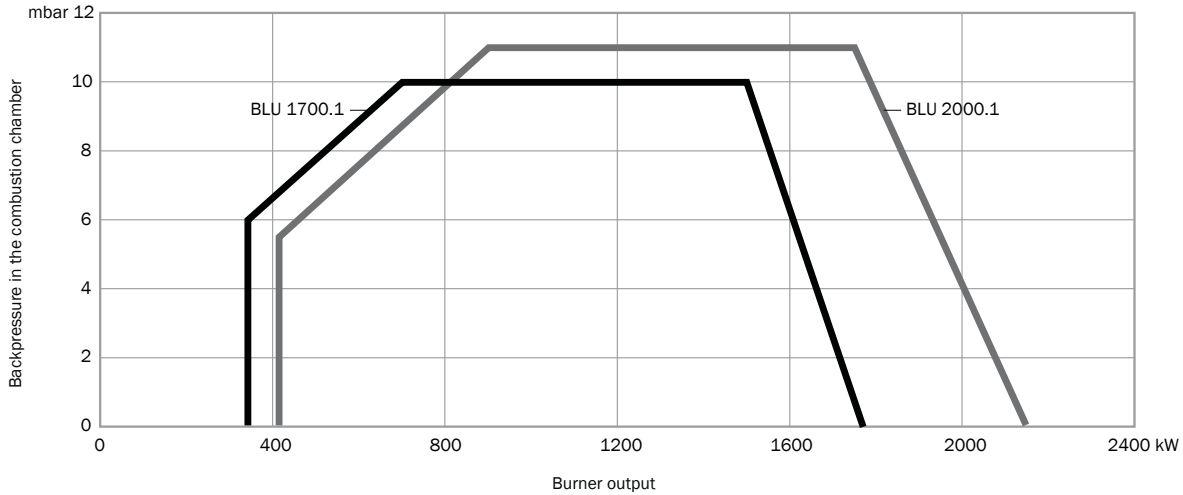

TECHNICAL DATA

	Burner output (kW)	Power supply	Motor (kW)	NOx class	Operation
BLU 1700.1	342 - 1770	3/230-400/50Hz	3	Class 2	PAB, PR, PRE
BLU 2000.1	414 - 2150	3/400/50Hz	4	Class 2	PAB, PR, PRE

OVERALL DIMENSIONS

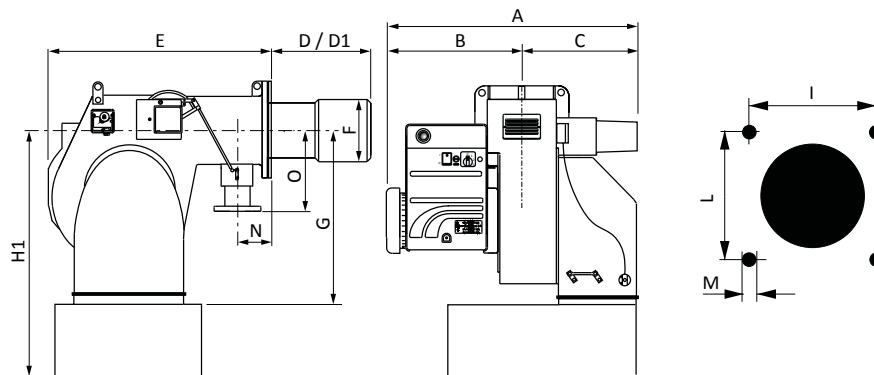

Dimensions in mm
 Head length: **D** short / **D1** long
 *: with silencer (optional)

	A	B	C	D	D1	E	F	G	H1*	I	L	M	N	O
BLU 1700.1	710	385	325	340	540	660	250	398	681	240	240	M14	125	250
BLU 2000.1	730	405	325	345	545	660	270	398	681	240	240	M14	125	250

BURNERS

Two stages

Model	Head	Code
BLU 1700.1 PAB	TC	3140326
	TL	3140327
BLU 2000.1 PAB	TC	3140330
	TL	3140331

Two stage progressive/modulating mechanical

Model	Head	Code
BLU 1700.1 PR	TC	3140401
	TL	3140402
BLU 2000.1 PR	TC	3140403
	TL	3140404

Two stage progressive/modulating electronic

Model	Head	Code
BLU 1700.1 PRE	TC	3145120
	TL	3145121
BLU 2000.1 PRE	TC	3145122
	TL	3145123



BLU 2000.1 PAB

OTHER AVAILABLE CONFIGURATIONS

60 Hz	LPG	Continuous Ventilation (CV)	Post-purge
●	●	●	●

● Codes available on request

GAS TRAINS

	Pressure (mbar)		Model	Size	Codes for PAB and PR	Codes for PRE versions	Connection pipe	Filter
	min	max						
for BLU 1700.1	20	500	VGD 40.080	DN80	3142026	3144279	3142069	3142088
	45	500	VGD 20.503	2"	3123860	3144277	3142074	3121384
	60	360	MB-DLE 420	2"	3141847	3144273	3142074	included
	85	360	MB-DLE 415	1"1/2	3141846	3144272	3142074	included
for BLU 2000.1	23	500	VGD 40.080	DN80	3142026	3144279	3142069	3142088
	35	500	VGD 40.065	2"1/2	3124110	3144278	3142197	3124111
	60	500	VGD 20.503	2"	3123860	3144277	3142074	3121384
	75	360	MB-DLE 420	2"	3141847	3144273	3142074	included
	100	360	MB-DLE 415	1"1/2	3141846	3144272	3142074	included

! For minimum inlet pressures higher than 250 mbar, choose the pressure switch GW500 (to be fitted during installation on site) - see page 105
 For gas trains in EN676 Configuration a tightness control device must be included over 1200 kW (already included on PRE burners) - see page 112

- Fuels: natural gas, LPG
- Operation: two stage progressive or modulating with the installation of a power regulator and dedicated probes (see page 102)
- Emission class: Low NOx class 2 (≤ 120 mg/kWh) according to EN676

WORKING DIAGRAM

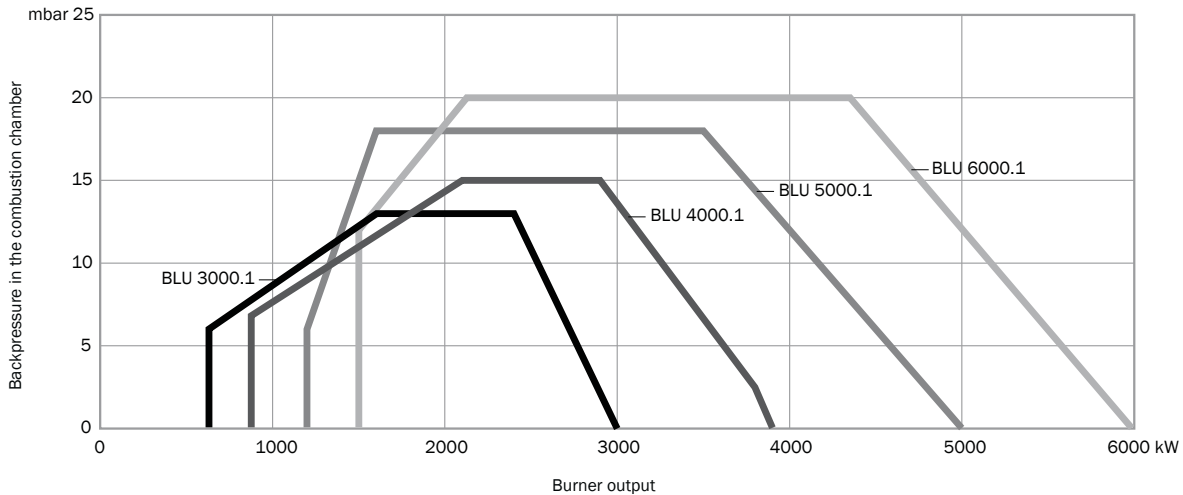

TECHNICAL DATA

	Burner output (kW)	Power supply	Motor (kW)	NOx class	Operation
BLU 3000.1	630 - 3000	3/400/50Hz	5,5	Class 2	PR, PRE
BLU 4000.1	875 - 3900	3/400/50Hz	7,5	Class 2	PR, PRE
BLU 5000.1	1200 - 5000	3/400/50Hz	11	Class 2	PR, PRE
BLU 6000.1	1500 - 6000	3/400/50Hz	15	Class 2	PR, PRE

OVERALL DIMENSIONS

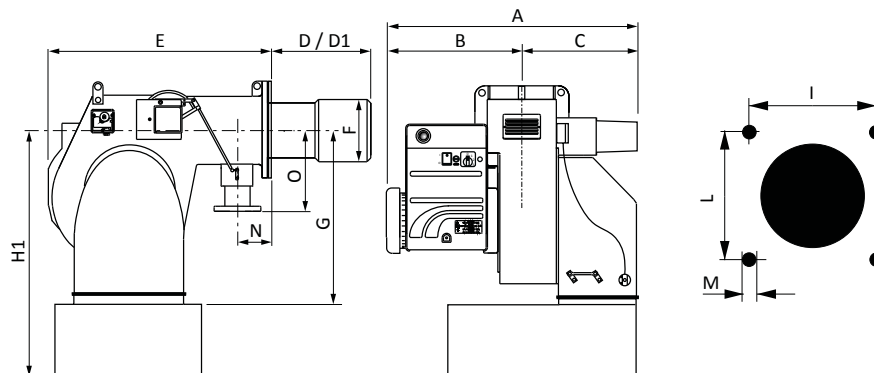

Dimensions in mm
 Head length: **D** short / **D1** long
 *: with silencer (optional)

	A	B	C	D	D1	E	F	G	H1*	I	L	M	N	O
BLU 3000.1	941	448	493	330	530	780	290	471	746	315	315	M16	195	250
BLU 4000.1	941	448	493	365	565	780	320	471	746	315	315	M16	195	250
BLU 5000.1	1019	495	524	375	575	970	320	570	965	330	330	M16	195	250
BLU 6000.1	1069	545	524	375	575	970	360	570	965	330	330	M16	195	250

BURNERS

Two stage progressive/modulating mechanical

Model	Head	Code
BLU 3000.1 PR	TC	3141753
	TL	3141754
BLU 4000.1 PR	TC	3141756
	TL	3141757
BLU 5000.1 PR	TC	3141758
	TL	3141759
BLU 6000.1 PR	TC	3141761
	TL	3141762



BLU 6000.1 PR

Two stage progressive/modulating electronic

Model	Head	Code
BLU 3000.1 PRE	TC	3145124
	TL	3145125
BLU 4000.1 PRE	TC	3145126
	TL	3145127
BLU 5000.1 PRE	TC	3145128
	TL	3145129
BLU 6000.1 PRE	TC	3145130
	TL	3145131

OTHER AVAILABLE CONFIGURATIONS

60 Hz	LPG	Continuous Ventilation (CV)	Post-purge
●	●	●	●

● Codes available on request

GAS TRAINS

	Pressure (mbar)		Model	Size	Codes for PR versions	Codes for PRE versions	Connection pipe	Filter
	min	max						
for BLU 3000.1	22	500	VDG 40.100	DN100	3141869	3144280	3142069+3142073*	3142205
	35	500	VDG 40.080	DN80	3142026	3144279	3142069	3142088
	55	500	VDG 40.065	DN65	3124110	3144278	3142197	3124111
	100	500	VDG 20.503	2"	3123860	3144277	3142075	3121384
for BLU 4000.1	30	500	VDG 40.100	DN100	3141869	3144280	3142069+3142073*	3142205
	50	500	VDG 40.080	DN80	3142026	3144279	3142069	3142088
	90	500	VDG 40.065	DN65	3124110	3144278	3142197	3124111
	170	500	VDG 20.503	2"	3123860	3144277	3142075	3121384
for BLU 5000.1	35	500	VDG 40.125	DN125	3142666	3144282	3142198	3142206
	45	500	VDG 40.100	DN100	3141869	3144280	3142070+3142073*	3142205
	75	500	VDG 40.080	DN80	3142026	3144279	3142070	3142088
	140	500	VDG 40.065	DN65	3124110	3144278	3142071	3124111
for BLU 6000.1	250	500	VDG 20.503	2"	3123860	3144277	3142075	3121384
	50	500	VDG 40.125	DN125	3142666	3144282	3142198	3142206
	60	500	VDG 40.100	DN100	3141869	3144280	3142070+3142073*	3142205
	100	500	VDG 40.080	DN80	3142026	3144279	3142070	3142088
	180	500	VDG 40.065	DN65	3124110	3144278	3142071	3124111
	340	500	VDG 20.503	2"	3123860	3144277	3142075	3121384

*: both codes have to be selected in case of order

! Default blank spring: head pressure 0...22 mbar; choose and change spring and damping (to be fitted during installation on site) - see page 105
 For minimum inlet pressures higher than 250 mbar, choose the pressure switch GW500 (to be fitted during installation on site) - see page 105
 For gas trains in EN676 Configuration a tightness control device must be included over 1200 kW (already included on PRE burners) - see page 112

Range | Models
BLU 7000.1 - 8000.1 - 10000.1 - 12000.1

- Fuels: natural gas, LPG
- Operation: two stage progressive or modulating with the installation of a power regulator and dedicated probes (see page 102)
- Emission class: Low NOx class 2 (≤ 120 mg/kWh) according to EN676

WORKING DIAGRAM

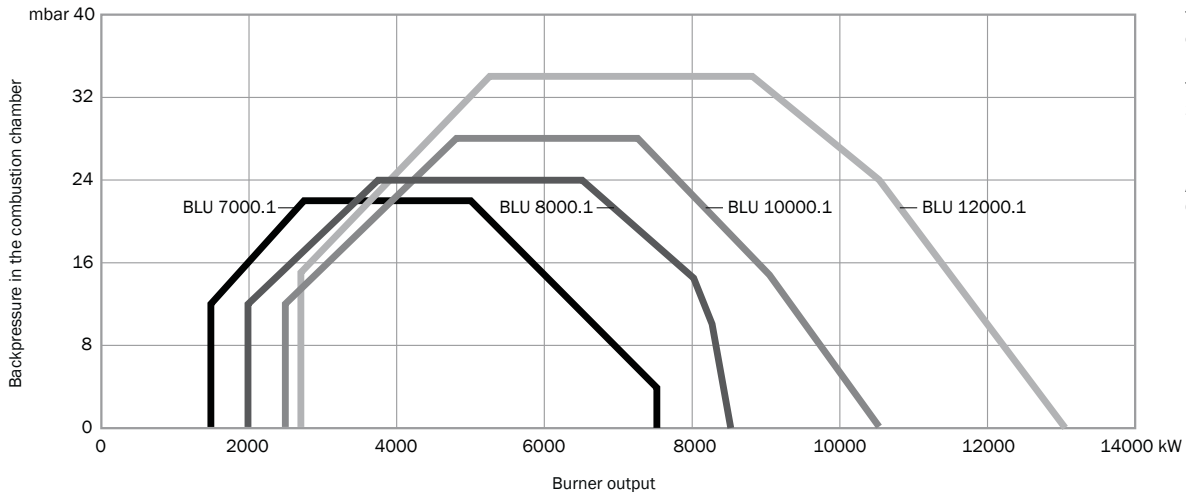

Test conditions conforming to EN676
 Temperature: 20°C
 Pressure: 1013,5 mbar
 Altitude: 0 m a.s.l.

TECHNICAL DATA

	Burner output (kW)	Power supply	Motor (kW)	NOx class	Operation
BLU 7000.1	1500 - 7500	3/400/50Hz	15	Class 2	PR, PRE
BLU 8000.1	2000 - 8500	3/400/50Hz	18,5	Class 2	PR, PRE
BLU 10000.1	2500 - 10500	3/400/50Hz	22	Class 2	PR, PRE
BLU 12000.1	2700 - 13000	3/400/50Hz	37	Class 2	PR, PRE

OVERALL DIMENSIONS

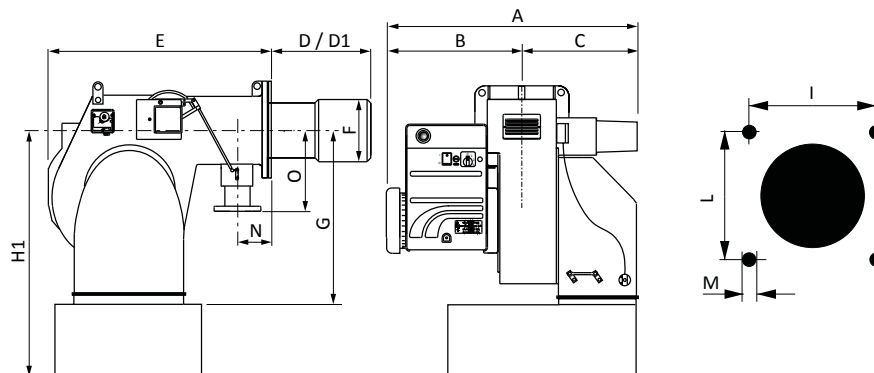

Dimensions in mm
 Head length: **D** short / **D1** long
 *: with silencer (optional)

	A	B	C	D	D1	E	F	G	H1*	I	L	M	N	O
BLU 7000.1	1210	585	625	470	-	1212	420	775	1270	460	460	M20	195	232
BLU 8000.1	1280	655	625	470	-	1212	420	775	1270	460	460	M20	195	232
BLU 10000.1	1310	685	625	470	-	1212	420	775	1270	460	460	M20	195	232
BLU 12000.1	1420	795	625	470	-	1212	450	775	1270	460	460	M20	195	232

BURNERS

Two stage progressive/modulating mechanical

Model	Head	Code
BLU 7000.1 PR	TC	3143747
BLU 8000.1 PR	TC	3143748
BLU 10000.1 PR	TC	3143749
BLU 12000.1 PR	TC	3143750

Two stage progressive/modulating electronic

Model	Head	Code
BLU 7000.1 PRE	TC	3145132
BLU 8000.1 PRE	TC	3145133
BLU 10000.1 PRE	TC	3145134
BLU 12000.1 PRE	TC	3145135



BLU 8000.1 PR

OTHER AVAILABLE CONFIGURATIONS

60 Hz	Continuous Ventilation (CV)	Post-purge
●	●	●

● Codes available on request

GAS TRAINS

	Pressure (mbar)		Model	Size	Codes for PR versions	Codes for PRE versions	Connection pipe	Filter
	min	max						
for BLU 7000.1	60	500	VDG 40.125	DN125	3142666	3144282	3142422+3142425*	3142206
	75	500	VDG 40.100	DN100	3141869	3144280	3142422	3142205
	140	500	VDG 40.080	DN80	3142026	3144279	3142424	3142088
	280	500	VDG 40.065	DN65	3124110	3144278	3142423	3124111
for BLU 8000.1	85	500	VDG 40.125	DN125	3142666	3144282	3142422+3142425*	3142206
	110	500	VDG 40.100	DN100	3141869	3144280	3142422	3142205
	210	500	VDG 40.080	DN80	3142026	3144279	3142424	3142088
	410	500	VDG 40.065	DN65	3124110	3144278	3142423	3124111
for BLU 10000.1	115	500	VDG 40.125	DN125	3142666	3144282	3142422+3142425*	3142206
	165	500	VDG 40.100	DN100	3141869	3144280	3142422	3142205
	290	500	VDG 40.080	DN80	3142026	3144279	3142424	3142088
	550	500	VDG 40.065	DN65	3124110	3144278	3142423	3124111
for BLU 12000.1	175	500	VDG 40.125	DN125	3142666	3144282	3142422+3142425*	3142206
	230	500	VDG 40.100	DN100	3141869	3144280	3142422	3142205
	420	500	VDG 40.080	DN80	3142026	3144279	3142424	3142088

*: both codes have to be selected in case of order

! Default blank spring: head pressure 0...22 mbar; choose and change spring and damping (to be fitted during installation on site) - see page 105
 For minimum inlet pressures higher than 250 mbar, choose the pressure switch GW500 (to be fitted during installation on site) - see page 105
 For gas trains in EN676 Configuration a tightness control device must be included over 1200 kW (already included on PRE burners) - see page 112

Range | Models
BLU 15000.1 - 18000.1

- Fuels: natural gas, LPG
- Operation: two stage progressive or modulating with the installation of a power regulator and dedicated probes (see page 102)
- Emission class: Low NOx class 2 (≤ 120 mg/kWh) according to EN676

WORKING DIAGRAM

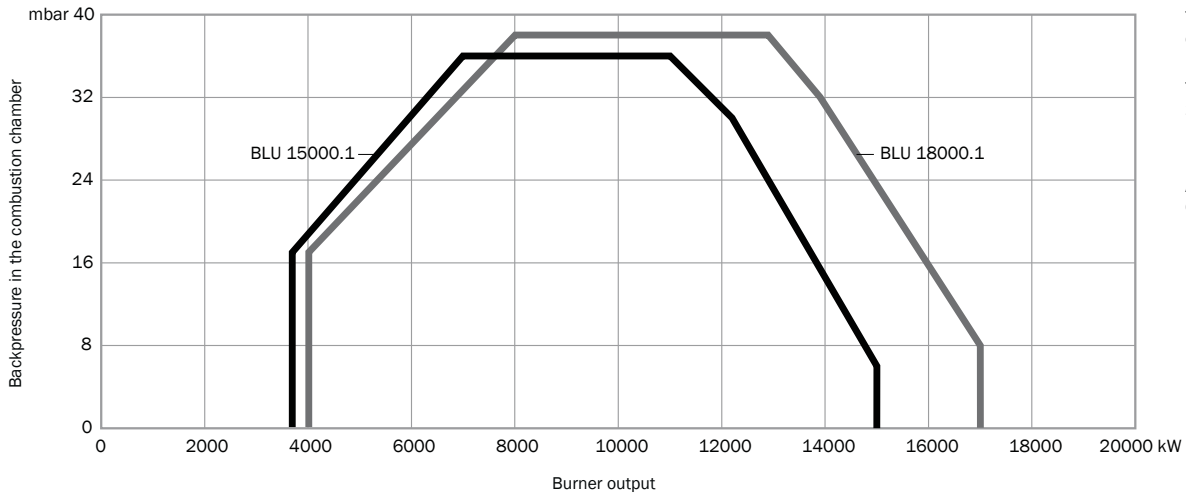

TECHNICAL DATA

	Burner output (kW)	Power supply	Motor (kW)	NOx class	Operation
BLU 15000.1	3690 - 15000	3/400/50Hz	45	Class 2	PR, PRE
BLU 18000.1	4000 - 17000	3/400/50Hz	55	Class 2	PR, PRE

OVERALL DIMENSIONS

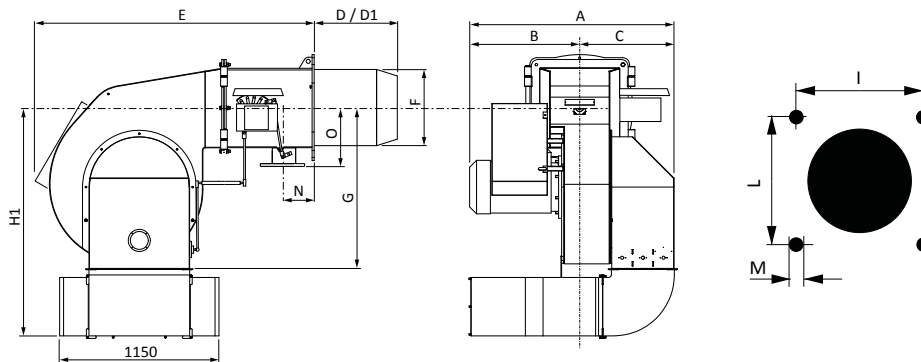

Dimensions in mm
 Head length: **D** short / **D1** long
 *: with silencer (optional)

	A	B	C	D	D1	E	F	G	H1*	I	L	M	N	O
BLU 15000.1	1530	810	720	590	-	1860	550	1320	1670	619	619	M20	210	320
BLU 18000.1	1580	860	720	590	-	1860	550	1320	1670	619	619	M20	210	320

BURNERS

Two stage progressive/modulating mechanical

Model	Head	Code
BLU 15000.1 PR	TC	3143751
BLU 18000.1 PR	TC	3143752

Two stage progressive/modulating electronic

Model	Head	Code
BLU 15000.1 PRE	TC	3145136
BLU 18000.1 PRE	TC	3145137



BLU 15000.1 PR

OTHER AVAILABLE CONFIGURATIONS

60 Hz	Continuous Ventilation (CV)	Post-purge
●	●	●

● Codes available on request

GAS TRAINS

	Pressure (mbar)		Model	Size	Codes for PR versions	Codes for PRE versions	Connection pipe	Filter
	min	max						
for BLU 15000.1	150	500	VGD 40.125	DN125	3142666	3144282	3142422+3142425*	3142206
	230	500	VGD 40.100	DN100	3141869	3144280	3142422	3142205
	450	500	VGD 40.080	DN80	3142026	3144279	3142424	3142088
for BLU 18000.1	210	500	VGD 40.125	DN125	3142666	3144282	3142422+3142425*	3142206
	330	500	VGD 40.100	DN100	3141869	3144280	3142422	3142205

*: both codes have to be selected in case of order

! Default blank spring: head pressure 0...22 mbar; choose and change spring and damping (to be fitted during installation on site) - see page 105
 For minimum inlet pressures higher than 250 mbar, choose the pressure switch GW500 (to be fitted during installation on site) - see page 105
 For gas trains in EN676 Configuration a tightness control device must be included over 1200 kW (already included on PRE burners) - see page 112

MODULATION KIT

MODULATING PID CONTROLLER - KIT FOR PROGRESSIVE VERSIONS

Model	Code
KITMD-RWF50	3143713
KITMD-RWF50 (only for MAX GAS 170...500 PR with Ariston BCU)	3143922
KITMD-RWF50 (only for MULTICALOR 45...200 PR-AB)	3144025
KITMD-RWF55	3143714
KITMD-RWF55.6 (PID controller with Profibus communication)	3143830



TEMPERATURE AND PRESSURE PROBES

Model	Designation	Code
Water probe up to 0÷130 °C	PROBE-WATER130C	3122316
Steam probe 0÷2 bar	PROBE-STEAM2BAR	3124100
Steam probe 0÷4 bar	PROBE-STEAM4BAR	3122317
Steam probe 0÷10 bar	PROBE-STEAM10BAR	3122318
Steam probe 0÷16 bar	PROBE-STEAM16BAR	3122319
Steam probe 0÷40 bar	PROBE-STEAM40BAR	3122320
Probe for external temperature from -35 ° up to 50 °C	PROBE-EXTERNAL50C	3122315
Hot air or liquid probe up to 0÷450 °C	PROBE-HOTAIR-LIQUID450C	3122314

GAS TRAINS

GAS TRAIN COMPOSITION

ECOFLAM gas trains are delivered separately for all gas and dual fuel burners and are available in different configurations:

- EN676 standard gas train + kit/accessories in compliance with EN676;
- Export configuration + other additional options to be added by installer in compliance with local safety regulations and codes of practise.

MULTIBLOC DUNGS

Compact double solenoid valve with built-in filter, gas governor and gas pressure switch

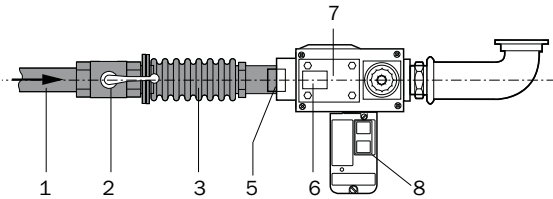

Configuration for electronic burners (PRE):

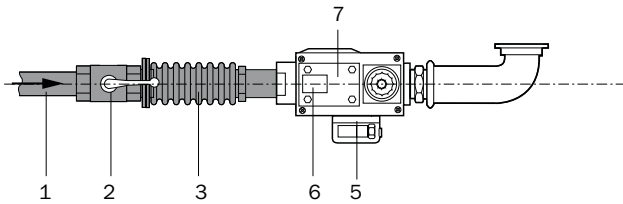

1. Main gas pipe		
2. Ball valve		ACS
3. Antivibrating joint		ACS
5. Gas pressure switch	EN676 CONFIGURATION	GAS TRAIN
6. Safety + Working gas valve		
7. Gas governor and filter		
8. Tightness control ⁽¹⁾		
Maximum gas pressure switch (kit)		KITPRES
Gas train connection pipe ⁽²⁾		GTCP ⁽²⁾

VGD SIEMENS

Double gas valve with actuators, gas regulator and gas pressure switch (gas filter not included)

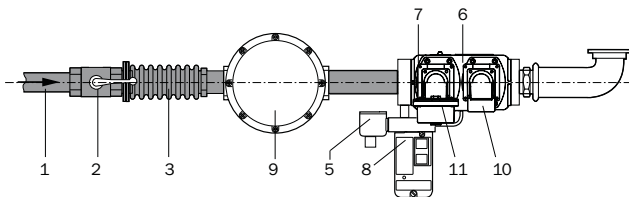

Configuration for electronic burners (PRE):

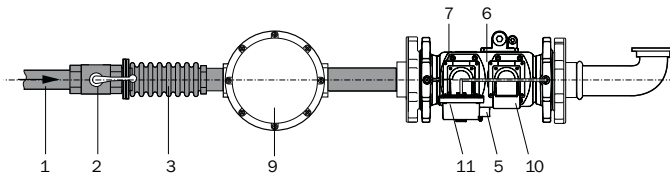

1. Main gas pipe		
2. Ball valve		ACS
3. Antivibrating joint		ACS
5. Gas pressure switch	EXPORT EN676 CONFIGURATION	GAS TRAIN
6. Safety gas valve + 10. Actuator		
7. Working gas valve + 11. Actuator		
8. Tightness control ⁽¹⁾		
9. Gas filter		ACS
Maximum gas pressure switch (kit)		KITPRES
Gas train connection pipe ⁽²⁾		GTCP ⁽²⁾

- !** ¹: according to the European Standard for gas trains in EN676 Configuration a tightness control device must be included over 1200 kW (already included on PRE burners)
²: starting from models BLU 1700.1 / MULTICALOR 170.1 / MULTIFLAM 300.1, in order to fit the gas train, the corresponding connection pipe must be ordered

! for VGD gas trains in EN676 Configuration a filter must be ordered as a separate device

! Default blank spring: head pressure 0...22 mbar; starting from BLU 3000.1/MULTICALOR 300.1/MULTIFLAM 300.1 choose and change spring and damping (to be fitted during installation on site)

! For minimum inlet pressures higher than 250 mbar, choose the pressure switch GW500 (to be fitted during installation on site)

● Gas trains for MAX GAS in EN676 Configuration

MB-DLE MultiBloc Dungs for MAX GAS 40-250

Model	Size	Code
GT-D1-MBC65DLE-RP15-MAXGAS40-120	RP 15 - 1/2"	3141885
GT-D1-MBC120DLE-RP20-MAXGAS40-120	RP 20 - 3/4"	3141886
GT-D1-MBDLE403-RP15-MAXGAS40-120	RP 15 - 1/2"	3123944
GT-D1-MBDLE405-RP20-MAXGAS40-120	RP 20 - 3/4"	3123560
GT-D1-MBDLE407-RP20-MAXGAS170-250	RP 20 - 3/4"	3123525
GT-D1-MBDLE410-RP25-MAXGAS170-250	RP 25 - 1"	3123947
GT-D1-MBDLE412-RP32-MAXGAS170-250	RP 32 - 1"1/4	3141899
GT-D1-MBDLE415-RP40-MAXGAS170-250	RP 40 - 1"1/2	3123969

MB-ZRDLE MultiBloc Dungs for MAX GAS 40-250

Model	Size	Code
GT-D2-MBZRDLE405-RP20-MAXGAS40-120	RP 20 - 3/4"	3123960
GT-D2-MBZRDLE407-RP20-MAXGAS170-250	RP 20 - 3/4"	3123961
GT-D2-MBZRDLE410-RP25-MAXGAS170-250	RP 25 - 1"	3123962
GT-D2-MBZRDLE412-RP32-MAXGAS170-250	RP 32 - 1"1/4	3141901
GT-D2-MBZRDLE415-RP40-MAXGAS170-250	RP 40 - 1"1/2	3123879

MB-DLE MultiBloc Dungs for MAX GAS 350-500

Model	Size	Code
GT-D2-MBDLE407-RP20-MAXGAS350-500	RP 20 - 3/4"	3142392
GT-D2-MBDLE410-RP25-MAXGAS350-500	RP 25 - 1"	3142665
GT-D2-MBDLE412-RP32-MAXGAS350-500	RP 32 - 1"1/4	3142295
GT-D2-MBDLE415-RP40-MAXGAS350-500	RP 40 - 1"1/2	3142296

! "EN676 Configuration" includes all the mandatory components in order to comply with EN676 regulation. Additional accessories and kits shall be installed by the installer in accordance to the local safety regulations and codes of practise.

● Gas trains for MAX GAS in EXPORT Configuration

Export gas trains for MAX GAS 40-250

Model	Size	Code
GT-B1-E6GSRP-RP15-MAXGAS40-120	RP 15 - 1/2"	3141888
GT-B1-EG12L-RP15-MAXGAS40-120	RP 15 - 1/2"	3141887
GT-K1-VAS125-RP25-MAXGAS170-250	RP 25 - 1"	3142815
GT-K1-VAS240-RP40-MAXGAS170-250	RP 40 - 1"1/2	3142816

! Additional accessories and kits shall be installed by the installer in accordance to the local safety regulations and codes of practise.

GAS TRAINS | BLU, MULTICALOR AND MULTIFLAM

● Gas trains for BLU, MULTICALOR and MULTIFLAM in EN676 Configuration

Model	Size	Code
GT-D2-MBDLE407-RP20-BLU/MULTI	RP 20 - 3/4"	3141843
GT-D2-MBDLE410-RP25-BLU/MULTI	RP 25 - 1"	3142022
GT-D2-MBDLE412-RP32-BLU/MULTI	RP 32 - 1"1/4	3141845
GT-D2-MBDLE415-RP40-BLU/MULTI	RP 40 - 1"1/2	3141846
GT-D2-MBDLE420-RP50-BLU/MULTI	RP 50 - 2"	3141847

● Gas trains for BLU, MULTICALOR and MULTIFLAM in EXPORT Configuration

Model	Size	Code
GT-S1-VGD20-RP50-PS1	RP 50 - 2"	3123860
GT-S1-VGD40-DN65-PS1	DN 65	3124110
GT-S1-VGD40-DN80-PS1	DN 80	3142026
GT-S1-VGD40-DN100-PS1	DN 100	3141869
GT-S1-VGD40-DN125-PS1	DN 125	3142666
Gas pressure switch GW500 A5 150+500 mbar for VGD4x (flanged valves)		3143350
Gas pressure switch GW500 A6 150+500 mbar for VGD20 (threaded valves)		3145164
Yellow spring	Head pressure: 15...120 mbar	3142204
Damping throttle		3142207

! Default blank spring: head pressure 0...22 mbar; starting from BLU 3000.1/MULTICALOR 300.1/MULTIFLAM 300.1 choose the yellow spring and the damping throttle (to be fitted during installation on site)

! For minimum inlet pressures higher than 250 mbar, choose the pressure switch GW500 (to be fitted during installation on site)

GAS TRAINS FOR ELECTRONIC VERSION BURNERS (PRE)

● Gas trains for BLU PRE, MULTICALOR PRE and MULTIFLAM PRE in EN676 Configuration

Model	Size	Code
GT-D2-MBDLE407-RP20-BLU/MULTI PS2	RP 20 - 3/4"	3144269
GT-D2-MBDLE410-RP25-BLU/MULTI PS2	RP 25 - 1"	3144270
GT-D2-MBDLE412-RP32-BLU/MULTI PS2	RP 32 - 1"1/4	3144271
GT-D2-MBDLE415-RP40-BLU/MULTI PS2	RP 40 - 1"1/2	3144272
GT-D2-MBDLE420-RP50-BLU/MULTI PS2	RP 50 - 2"	3144273

● Gas trains for BLU PRE, MULTICALOR PRE and MULTIFLAM PRE in EXPORT Configuration

Model	Size	Code
GT-S2-VGD20-RP50-BLU/MULTI PS2	RP 50 - 2"	3144277
GT-S2-VGD40-DN65-BLU/MULTI PS2	DN 65	3144278
GT-S2-VGD40-DN80-BLU/MULTI PS2	DN 80	3144279
GT-S2-VGD40-DN100-BLU/MULTI PS2	DN 100	3144280
GT-S2-VGD40-DN125-BLU/MULTI PS2	DN 125	3144282
Gas pressure switch GW500 A5 150+500 mbar for VGD4x (flanged valves)		3143350
Gas pressure switch GW500 A6 150+500 mbar for VGD20 (threaded valves)		3145164
Yellow spring	Head pressure: 15...120 mbar	3142204
Damping throttle		3142207

! Default blank spring: head pressure 0...22 mbar; starting from BLU 3000.1/MULTICALOR 300.1/MULTIFLAM 300.1 choose the yellow spring and the damping throttle (to be fitted during installation on site)

! For minimum inlet pressures higher than 250 mbar, choose the pressure switch GW500 (to be fitted during installation on site)

GAS TRAINS | DIMENSIONS

MAX GAS 40 ... 250

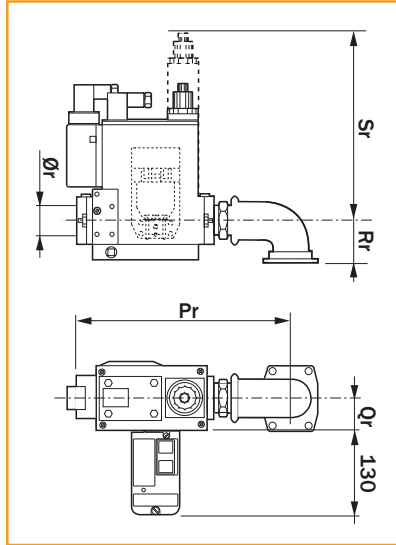

MAX GAS 350 - 500

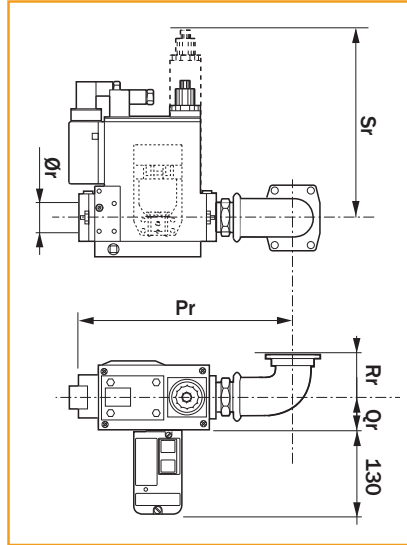

BLU / MULTICOLOR / MULTIFLAM

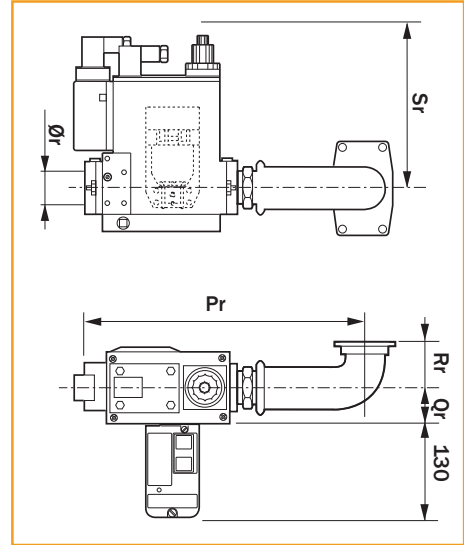

Code	Gas Train	Ø	Dimensions (mm)				
			Pr	Qr	Rr	Sr	Ør
3141885	GT-D1-MBC65DLE-RP15-MAXGAS40-120	RP 15 - 1/2"	250	42	35	140	1/2"
3141886	GT-D1-MBC120DLE-RP15-MAXGAS40-120	RP 15 - 1/2"	260	42	35	140	1/2"
3123944	GT-D1-MBDLE403-RP15-MAXGAS40-120	RP 15 - 1/2"	150	29	35	144	1/2"
3123560	GT-D1-MBDLE405-RP20-MAXGAS40-120	RP 20 - 3/4"	194	55	35	140	3/4"
3123525	GT-D1-MBDLE407-RP20-MAXGAS170-250	RP 20 - 3/4"	194	55	55	140	3/4"
3123947	GT-D1-MBDLE410-RP25-MAXGAS170-250	RP 25 - 1"	218	62	55	160	1"
3141899	GT-D1-MBDLE412-RP32-MAXGAS170-250	RP 32 - 1"1/4"	218	62	55	160	1"1/4"
3123960	GT-D2-MBZRDLE405-RP20-MAXGAS40-120	RP 20 - 3/4"	194	50	35	210	3/4"
3123961	GT-D2-MBZRDLE407-RP20-MAXGAS170-250	RP 20 - 3/4"	194	62	55	210	3/4"
3123962	GT-D2-MBZRDLE410-RP25-MAXGAS170-250	RP 25 - 1"	223	62	55	260	1"
3141901	GT-D2-MBZRDLE412-RP32-MAXGAS170-250	RP 32 - 1"1/4"	223	62	55	260	1"1/4"
3142392	GT-D1-MBDLE407-RP20-MAXGAS350-500	RP 20 - 3/4"	335	55	150	140	3/4"
3142665	GT-D1-MBDLE410-RP25-MAXGAS350-500	RP 25 - 1"	335	62	150	160	1"
3142295	GT-D1-MBDLE412-RP32-MAXGAS350-500	RP 32 - 1"1/4"	335	62	150	160	1"1/4"
3142296	GT-D1-MBDLE415-RP40-MAXGAS350-500	RP 40 - 1"1/2"	400	50	150	175	1"1/2"
3141843	GT-D1-MBDLE407-RP20-BLU/MULTI	RP 20 - 3/4"	315	55	85	140	3/4"
3142022	GT-D1-MBDLE410-RP25-BLU/MULTI	RP 25 - 1"	330	62	85	160	1"
3141845	GT-D1-MBDLE412-RP32-BLU/MULTI	RP 32 - 1"1/4"	330	62	85	160	1"1/4"
3141846	GT-D1-MBDLE415-RP40-BLU/MULTI	RP 40 - 1"1/2"	410	50	85	175	1"1/2"
3141847	GT-D1-MBDLE420-RP50-BLU/MULTI	RP 50 - 2"	420	50	85	175	2"

GAS TRAINS FOR ELECTRONIC VERSION BURNERS (PRE)

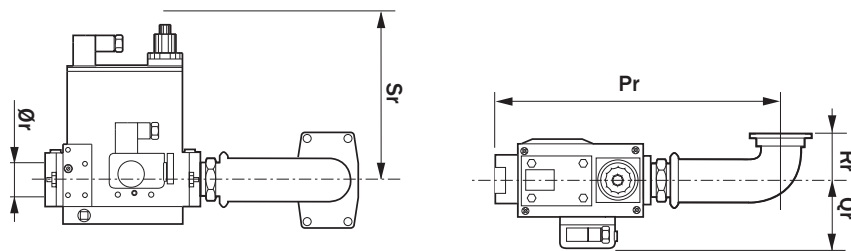

Code	Gas Train	Ø	Dimensions (mm)				
			Pr	Qr	Rr	Sr	Ør
3144270	GT-D1-MBDLE410-RP25-BLU/MULTI PS2	RP 25 - 1"	330	102	85	160	1"
3144271	GT-D1-MBDLE412-RP32-BLU/MULTI PS2	RP 32 - 1"1/4"	330	102	85	160	1"1/4"
3144272	GT-D1-MBDLE415-RP40-BLU/MULTI PS2	RP 40 - 1"1/2"	410	90	85	175	1"1/2"
3143970	GT-D1-MBDLE415-RP40-BLU/MULTI BT320	RP 40 - 1"1/2"	410	90	85	175	1"1/2"
3144273	GT-D1-MBDLE420-RP50-BLU/MULTI PS2	RP 50 - 2"	420	90	85	175	2"

GAS TRAINS | DIMENSIONS

GAS TRAIN CONNECTION PIPE

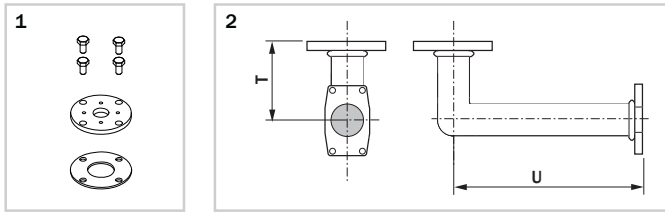

Code	Designation	Ø	Ref.	Dimensions (mm)	
				T	U
3122300	MAX GAS 170-250	RP 25 - 1"	1	588	1"
3142074	GTCP-RP50-280	RP 32 - 1"1/4	2	330	1"1/4
3142075	GTCP-RP50-280/320/380	RP 40 - 1"1/2	2	410	1"1/2

MAX GAS 170 - 250

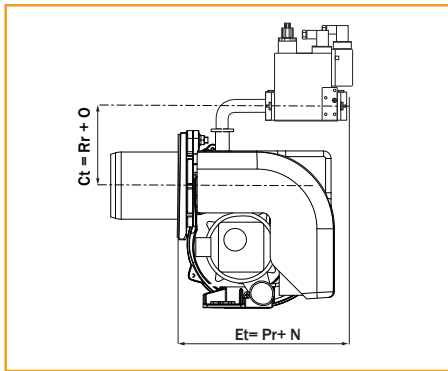

MAX GAS 350 - 500

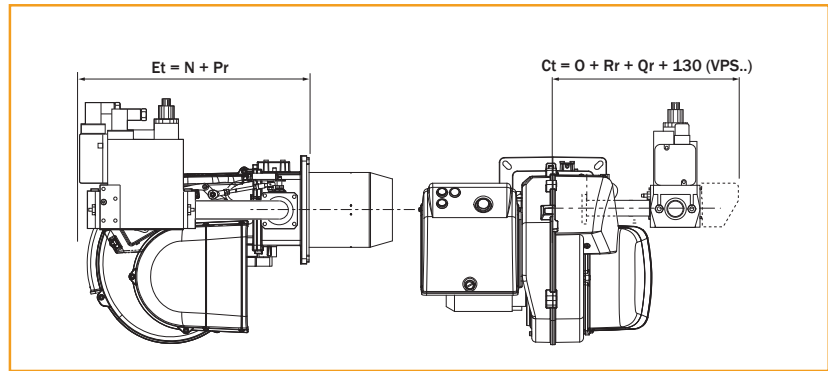

BLU 700.1 ... 1500.1 MULTICALOR 35 ... 140

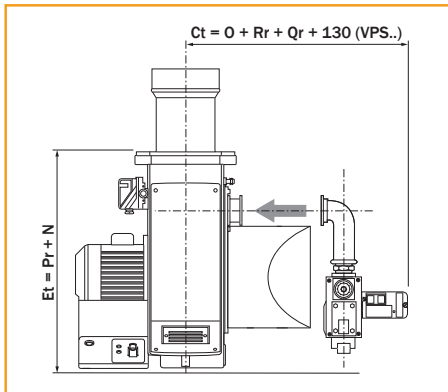

BLU TS 500.1 - TS 1000.1 MULTICALOR TS 100 - TS 140

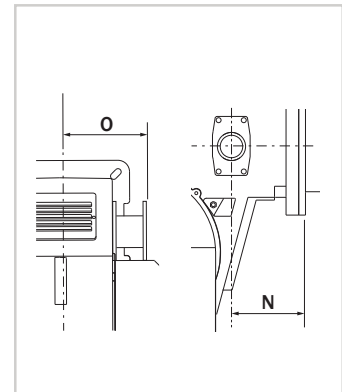
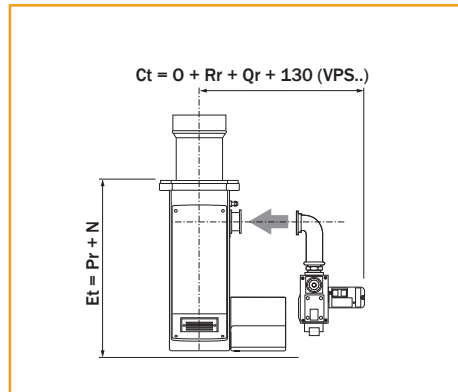

BLU 1700.1 - 2000.1 MULTICALOR 170.1 - 200.1

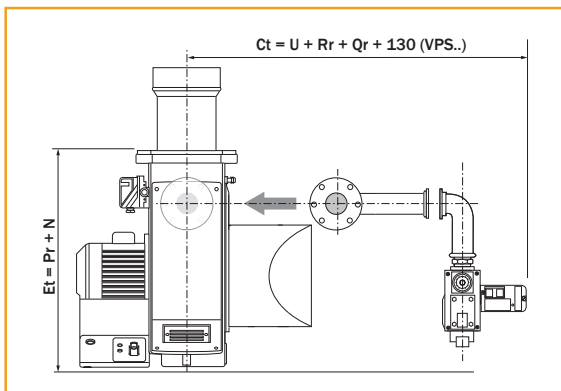

BLU TS 1500.1 ... TS 34000.1 MULTICALOR TS 200.1 ... TS 3400.1

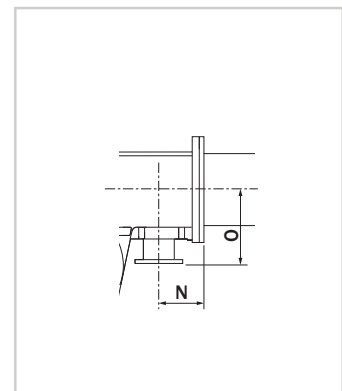
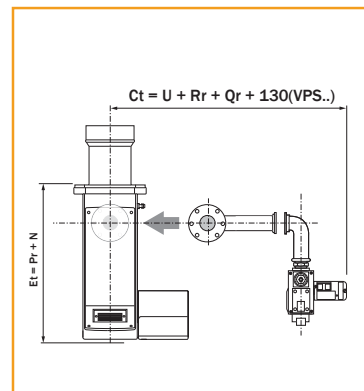

GAS TRAINS | DIMENSIONS

VGD 20...

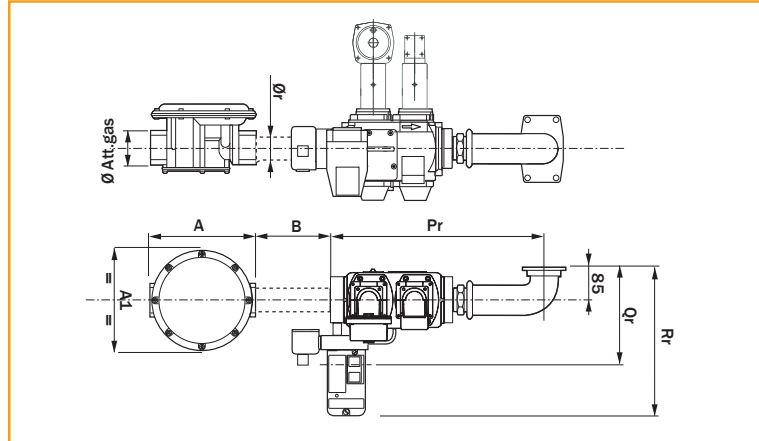

VGD 40...

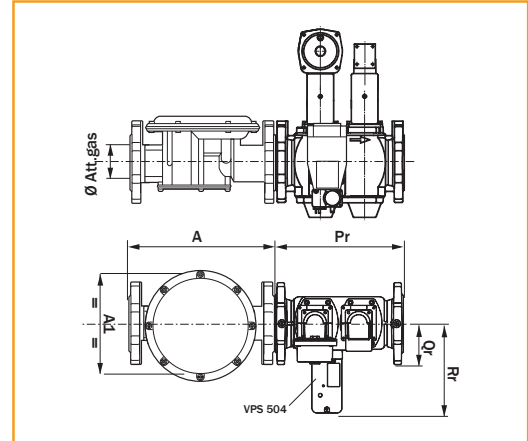

Code	Gas Train	Ø	Dimensions (mm)			
			Pr	Qr	Rr	Ør
3123860	GT-S1-VGD20-RP50-BLU/MULTI	RP 50 - 2"	450	185	315	2"
3124110	GT-S1-VGD40-DN65-BLU/MULTI	DN 65 - 2"1/2	290	97	211	DN65
3142026	GT-S1-VGD40-DN80-BLU/MULTI	DN 80 - 3"	310	102	218	DN80
3141869	GT-S1-VGD40-DN100-BLU/MULTI	DN 100 - 4"	350	113,5	229	DN100
3142666	GT-S1-VGD40-DN125-BLU/MULTI	DN 125 - 5"	400	127,5	243	DN125

GAS TRAINS FOR ELECTRONIC VERSION BURNERS (PRE)

VGD 20...

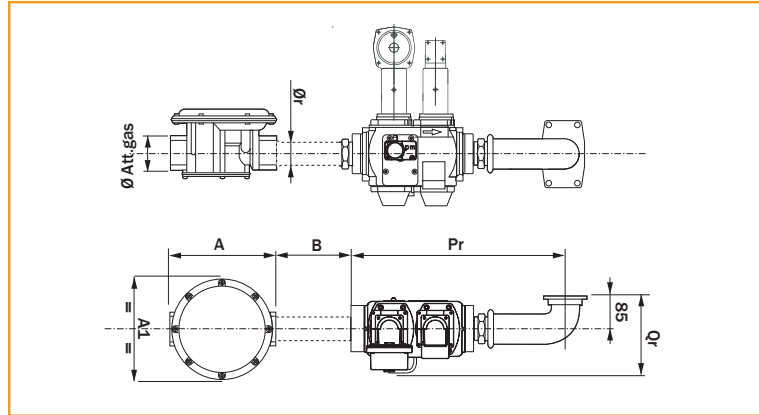

VGD 40...

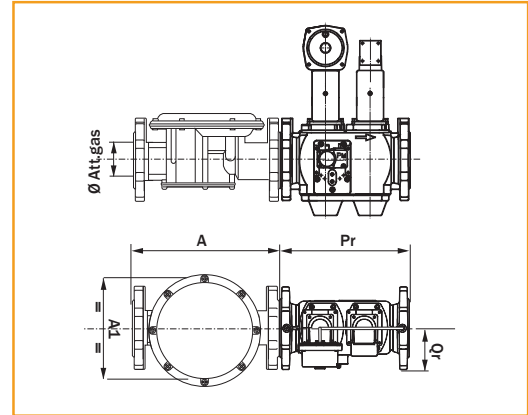

Code	Gas Train	Ø	Dimensions (mm)			
			Pr	Qr	Rr	Ør
3144277	GT-S1-VGD20-RP50-BLU/MULTI PS2	RP 50 - 2"	450	185	315	2"
3144278	GT-S1-VGD40-DN65-BLU/MULTI PS2	DN 65 - 2"1/2	290	97	-	DN65
3144279	GT-S1-VGD40-DN80-BLU/MULTI PS2	DN 80 - 3"	310	102	-	DN80
3144280	GT-S1-VGD40-DN100-BLU/MULTI PS2	DN 100 - 4"	350	113,5	-	DN100
3144282	GT-S1-VGD40-DN125-BLU/MULTI PS2	DN 125 - 5"	400	127,5	-	DN125

GAS FILTER

Code	Gas Train	Ø	Dimensions (mm)		
			A	A1	B
3121384	Gas filter RP 50 - 2"	RP 50 - 2"	186	186	>100
3124111	Gas filter DN 65	DN 65 - 2"1/2	290	212	-
3142088	Gas filter DN 80	DN 80 - 3"	320	240	-
3142205	Gas filter DN 100	DN 100 - 4"	380	280	-
3142206	Gas filter DN 125	DN 125 - 5"	380	280	-
3142808	Gas filter DN 150	DN 150 - 6"	450	310	-

GAS TRAINS | DIMENSIONS

GAS TRAIN CONNECTION PIPE

Code	Designation	Ref.	Dimensions (mm)		
			T	U	V
3142074	GTCP-RP50-280	1	85	400	-
3142075	GTCP-RP50-280/320/380	1	85	588	-
3142197	GTCP-DN65-280/320	2	104	560	104
3142069	GTCP-DN80-280/320	2	125	560	125
3142071	GTCP-DN65-380	2	125	668	125
3142070	GTCP-DN80-380	2	125	668	125
3142198	GTCP-DN125-380	2	125	718	164
3142423	GTCP-DN65-630	2	202	820	108
3142424	GTCP-DN80-630/710	2	221	820	129
3142422	GTCP-DN100-630/710	2	165	820	165
3142073	GTCP-REDUCERDN100TODN80	3	-	-	130
3142935	GTCP-ADAPTORDN80TODN65	3	-	-	120
3143080	GTCP-ADAPTORDN80TORP50	3	-	-	80
3142425	GTCP-REDUCERDN125TODN100*	3	-	-	137
3141842	GTCP-RP50-DN65-260	4	-	211	165

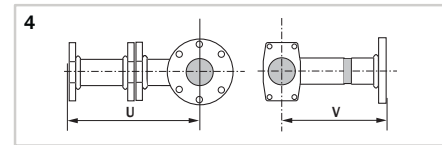
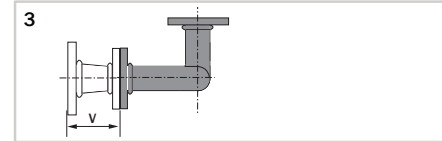
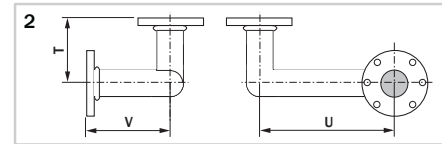
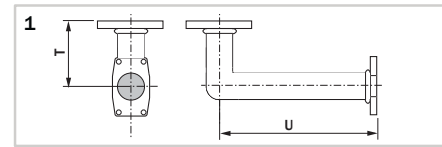

BLU 700.1 ... 1500.1
MULTICALOR 35 ... 140

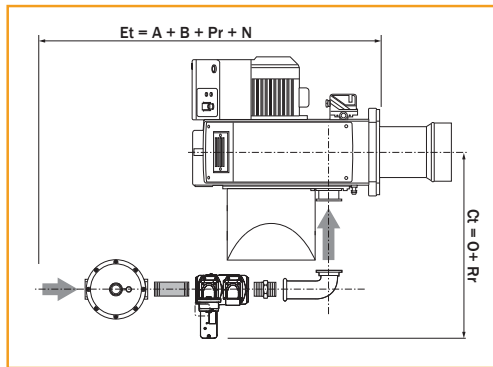

BLU TS 500.1 - TS 1000.1
MULTICALOR TS 100 - TS 140

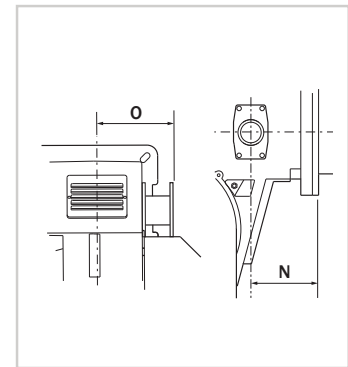
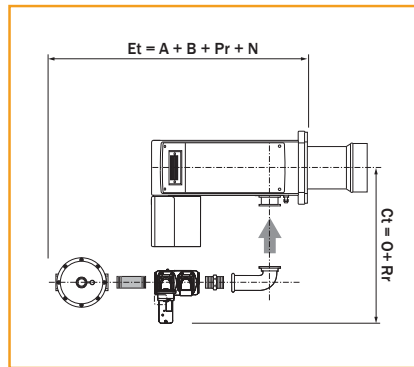

BLU 1700.1 ... 18000.1
MULTICALOR 170.1 ... 1800.1
MULTIFLAM 300.1 ... 1800.1

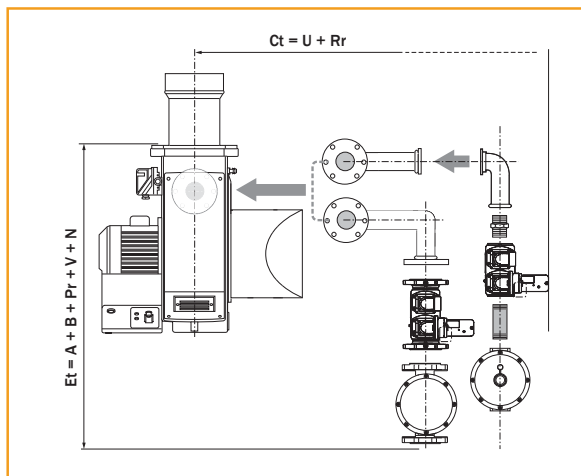

BLU TS 1500.1 ... TS 34000.1
MULTICALOR TS 200.1 ... TS 3400.1

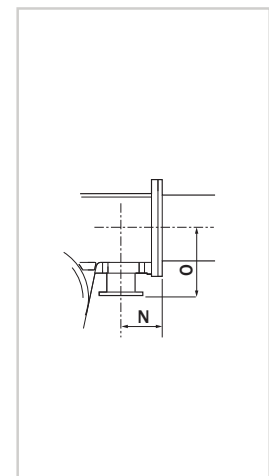
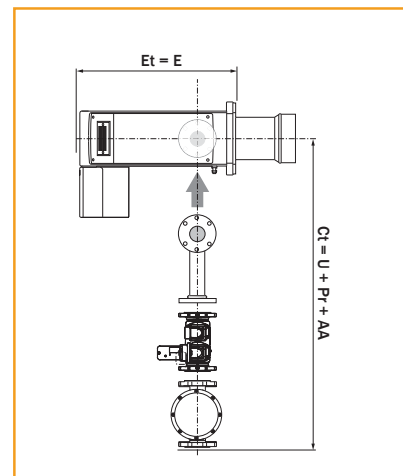

GAS GOVERNOR WITH BUILT-IN FILTER

Size	Maximum gas pressure	Code
RP 15 - 1/2" (*)	500 mbar	3142519
RP 20 - 3/4" (*)	500 mbar	3142520
RP 25 - 1" (*)	500 mbar	3142521
RP 32 - 1"1/4 (*)	500 mbar	3142522
RP 40 - 1"1/2 (*)	500 mbar	3142523
RP 50 - 2" (*)	500 mbar	3142524
RP50 - 2"	1 bar	3142051
DN 65	1 bar	3141983
DN 80	1 bar	3142538
DN 100	1 bar	on request
DN 125	1 bar	on request

*: Default spring is neutral for outlet pressure range 10 - 30 mbar

SPRINGS FOR GAS GOVERNOR

Model	Gas pressure range	Code
Green spring for sizes 1/2", 3/4", 1"	5÷15 mbar	3142547
Neutral spring for sizes 1/2", 3/4", 1"	10÷30 mbar	3142548
Violet spring for sizes 1/2", 3/4", 1"	25÷80 mbar	3142549
Brown spring for sizes 1/2", 3/4", 1"	70÷160 mbar	3142550
Blue spring for sizes 1/2", 3/4", 1"	150÷280 mbar	3142551
White spring for sizes 1/2", 3/4", 1"	270÷350 mbar	3142552
Green spring for sizes 1"1/4, 1" 1/2	5÷15 mbar	3142553
Neutral spring for sizes 1"1/4, 1" 1/2	10÷30 mbar	3142554
Violet spring for sizes 1"1/4, 1" 1/2	20÷70 mbar	3142555
Brown spring for sizes 1"1/4, 1" 1/2	65÷130 mbar	3142556
White spring for sizes 1"1/4, 1" 1/2	120÷250 mbar	3142557
Black spring for sizes 1"1/4, 1" 1/2	240÷350 mbar	3142558
Green spring for size 2"	5÷15 mbar	3142559
Neutral spring for size 2"	10÷30 mbar	3142560
Violet spring for size 2"	30÷80 mbar	3142561
Brown spring for size 2"	70÷220 mbar	3142562
Blue spring for size 2"	210÷350 mbar	3142563
Red spring for size DN 65-80	25-80 mbar	3144252
Violet spring for size DN 65-80	60-120 mbar	3144253
Blue spring for size DN 65-80	100-220 mbar	3144254
White spring for size DN 65-80	200-450 mbar	3144255
Red spring for size DN100	30-70 mbar	3144256
Violet spring for size DN100	60-110 mbar	3144257
Brown spring for size DN100	100-210 mbar	3144258
White spring Sfor size DN100	200-450 mbar	3144060

GAS FILTER

Size	Code
RP 15 - 1/2"	3141957
RP 20 - 3/4"	3142045
RP 25 - 1"	3142046
RP 40 - 1"1/2	3141954
RP 50 - 2"	3121384
DN 65	3124111
DN 80	3142088
DN 100	3142205
DN 125	3142206

ANTIVIBRATION JOINT

Size	Code
RP 15 - 1/2"	3122321
RP 20 - 3/4"	3122322
RP 25 - 1"	3122323
RP 32 - 1"1/4	3122324
RP 40 - 1"1/2	3122325
RP 50 - 2"	3122326
DN 65	3142060
DN 80	3122328
DN 100	3122329
DN 125	3142061

MANUAL VALVE

Size	Code
RP 15 - 1/2"	3142000
RP 20 - 3/4"	3142254
RP 25 - 1"	3121430
RP 32 - 1"1/4	3142253
RP 40 - 1"1/2	3142101
RP 50 - 2"	3142102
DN 65	3142062
DN 80	3143730
DN 100	3141997
DN 125	3141998

MAXIMUM GAS PRESSURE SWITCH

Model	Output range	Setting range	Code
KITPRES50	<6 MW	5÷50 mbar	3141921
KITPRES150	6 MW ÷ 15 MW	30÷150 mbar	3142033
KITPRES500	>15 MW	50÷500 mbar	3145166

TIGHTNESS CONTROL

Model	Designation	Code
Kit VPS504 for MB-DLE, MB-ZRDLE and VGD65/80/100 valves (not for LPG)	KITTC-VPS504-MB-VGDDN65-80-100	3122303
Kit VPS504 for MB-DLE, MB-ZRDLE and VGD65/80/100 valves (only for LPG)	KITTC-LPGVPS504-MB-VGDDN65-80-100	3142190
Kit VPS504 for VGD20503 valve (not for LPG)	KITTC-VPS504-VGD20503	3122305
Kit VPS504 for VGD20503 valve (only for LPG)	KITTC-LPGVPS504-VGD20503	3142688
Kit VDK for VGD DN125/DN150 valves	KITTC-VDK200	3141922
Kit LDU	KITTC-LDU11	3142314
Adaptor for VPS pilot gas train		3142754

! For gas trains in EN676 Configuration a tightness control device must be included over 1200 kW (already included on PRE burners)

MANOMETER + PUSH BUTTON

Model	Size	Code
Gas manometer	1/2", 0...60 mbar	3142056
Gas manometer	1/4", 0...250 mbar	3142055
Gas manometer	1/4", 0...1000 mbar	3142054
Push button 1/4"	1/4"	3142058
Push button 1/2"	1/2"	3142057

KIT LPG

Model	Burner	Code
KITLPG-MAXGAS40-120	MAX GAS 40 ... 120	3122301
KITLPG-MAXGAS170-250	MAX GAS 170 - 250	3122302
KITADAPTOR-MAXGAS170-250 (only for MB-xxx 405)	MAX GAS 170 - 250	3122300
KITLPG-MAXGAS350-500	MAX GAS 350 - 500	3142431
KIT LPG BLU 700.1/1500.1	BLU 700.1 ... 1500.1	3144610

HEAD OFFICE:
Via Roma, 64
31023 Resana (TV)

REGISTERED OFFICE:
Viale A. Merloni, 45
60044 Fabriano (AN)

Tel.: +39 0423 719500
Fax: +39 0423 719580
Email: export@ecoflam-burners.com

Company subject to the direction and coordination of Ariston Thermo SpA. Via A. Merloni, 45 - 60044 Fabriano (AN) - CF 01026940427

Version 1.1 - 02/10/2017

ECOFLAM Bruciatori S.p.A. reserve the right to make any adjustments, without prior notice, which is considered necessary or useful to its products, without affecting their main features.